

General purpose, side-entry velocity transducer with DC and temperature outputs. Made from robust stainless steel throughout for continuous vibration monitoring in harsh environments. Internal electronics are enclosed in a Faraday cage and isolated to minimise noise. Sealed to IP65 with industry standard 4-20mA output proportional to sensor and temperature range that can connect directly to PLC, DCS and other industrial controllers. Includes stainless steel overbraided ETFE cable and ¼" -28UNF, M6 or M8 mounting bolt.

MTN/2285STC

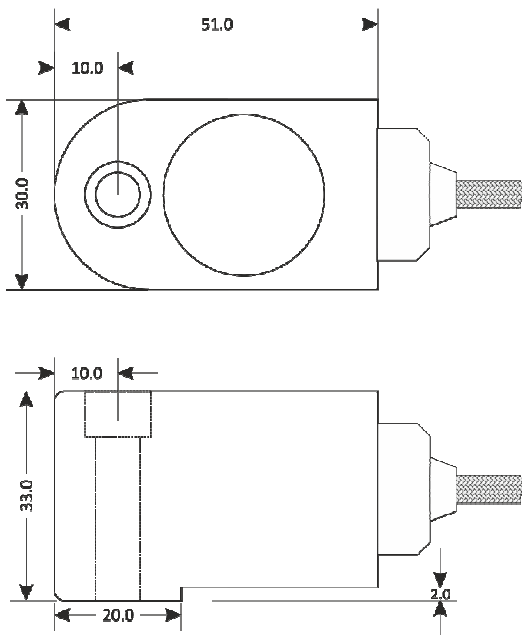

Dimensions



Applications

- Pumps, fans and compressors
- Building services
- Paper industry

Technical

Output current 4-20mA DC proportional to rms velocity (mm/s)

Temperature output 10mV/°C

Supply voltage range 12-32V DC (4-20mA)

Frequency response 2Hz to 800Hz ±10%

Mounted base resonance 5kHz (nominal)

Isolation Electronics in Faraday cage, isolated from body

Dynamic range 50g peak

Transverse sensitivity Less than 5%

Operating temperature -25 to 90°C

Temperature sensitivity 0.08%/°C

Case material Stainless steel

Cable Integral stainless steel overbraided ETFE - length to be specified at point of order

Standard cable length 5m

Maximum cable length 100m

Mounting torque 8Nm

Weight 440g (nominal)

Sealing IP65

System connection

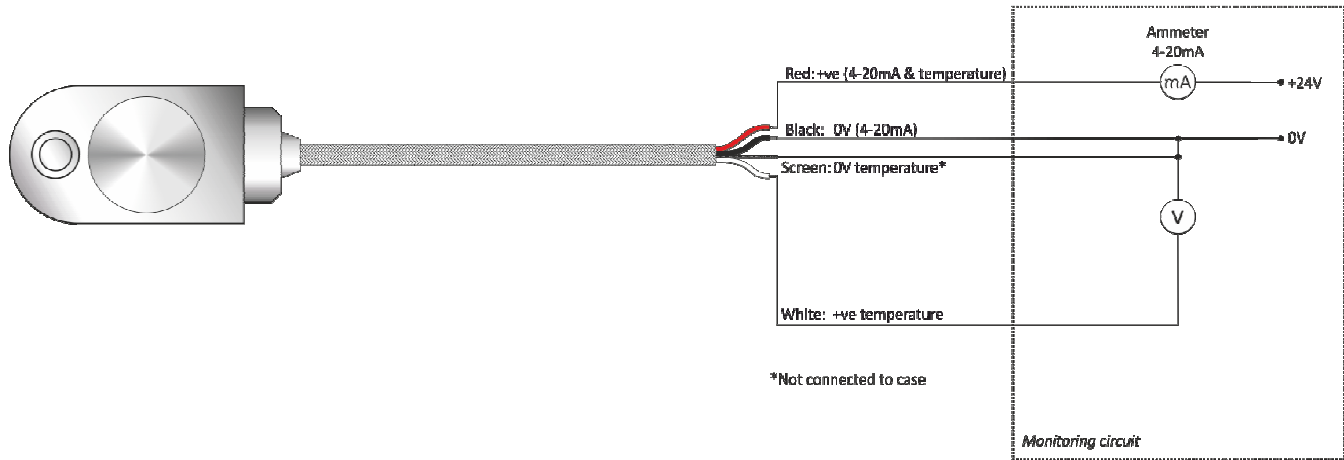

Options

- Filters
- Mounting threads
- Mating connectors and cable assemblies
- Other velocities (see below)

| Part # | Mounting | xx = Optional velocity (mm/s rms) |
|----------------|---------------|-----------------------------------|
| MTN/2285STC-xx | ¼" UNF Female | 0-10 0-20 |
| MTN/2285STC-xx | M6 x 35mm | 0-25 0-50 |
| MTN/2285STC-xx | M8 x 28mm | 0-100 |